

tables:  
18 → 120 x 88  
24 → 18 x 88

SORTIE SECOURS

Dégagement tables et chaises  
10<sup>m</sup> 20  
SCENE

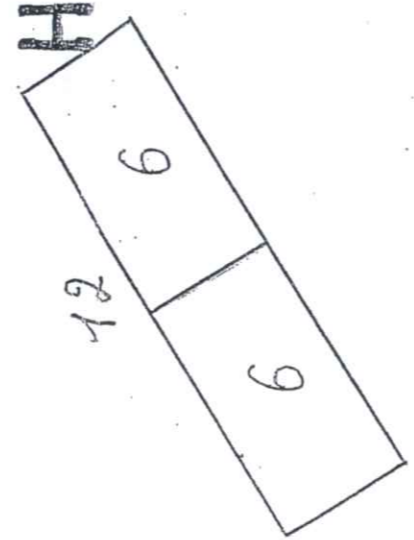
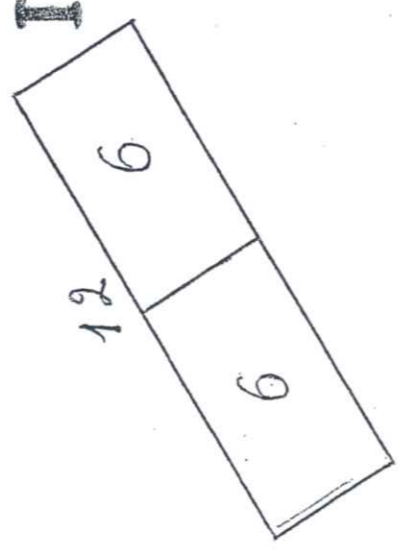
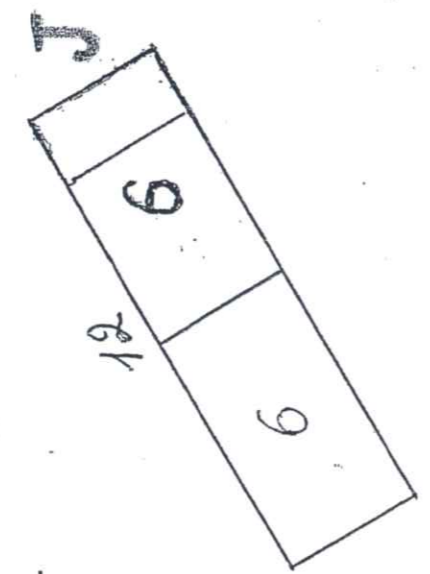
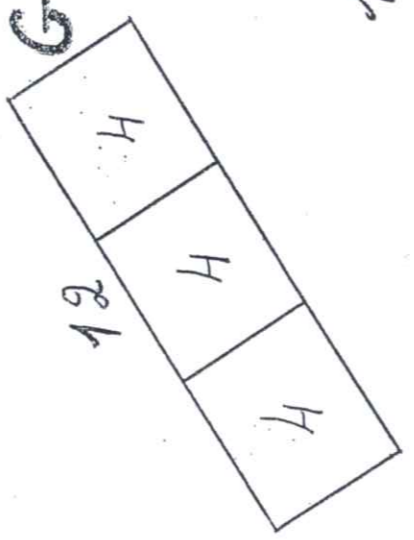
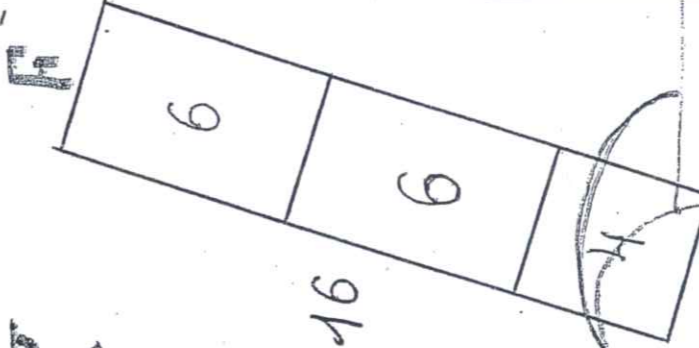
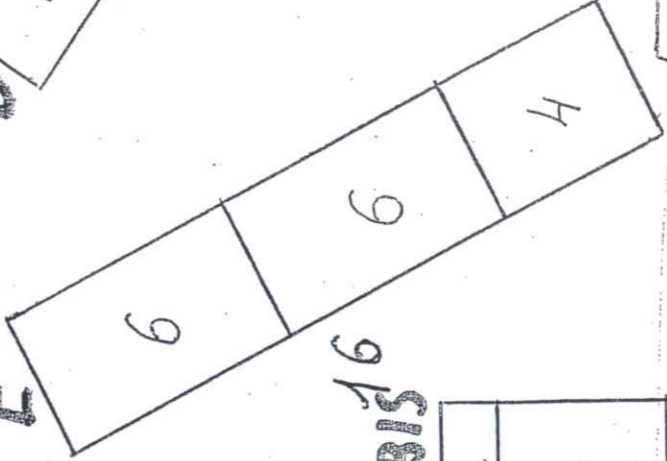
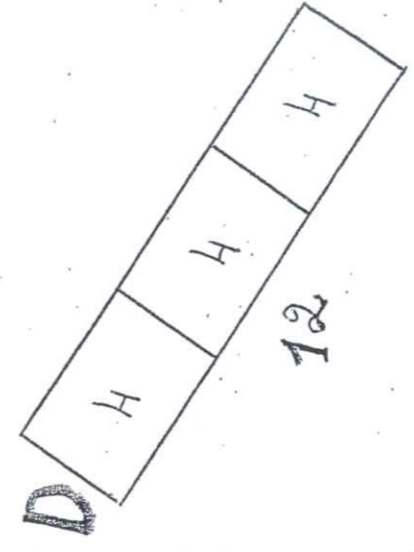
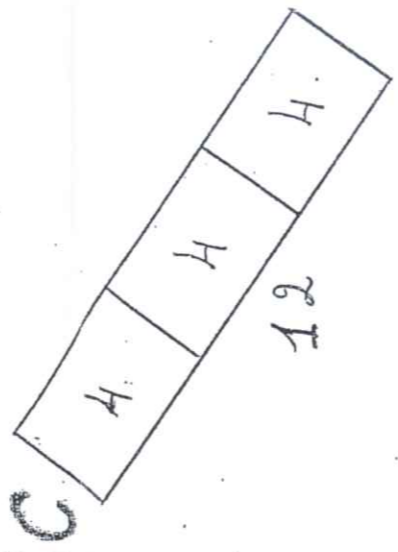
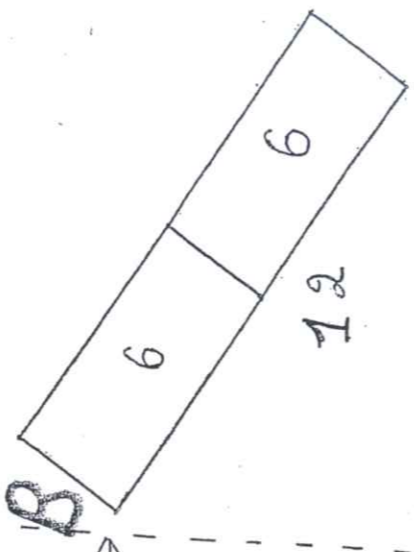
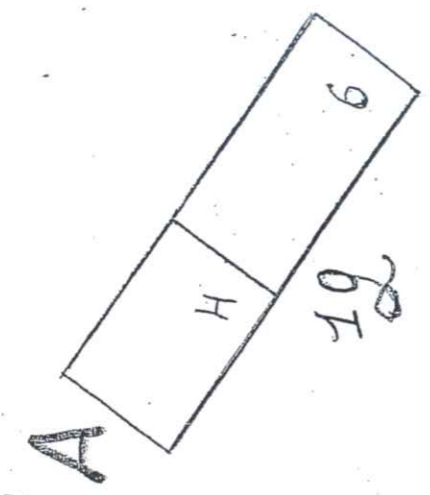

de  
5<sup>m</sup> 1,00  
Danse  
Superficie: 47 m<sup>2</sup>  
9<sup>m</sup> 40

Piste

FBI 16

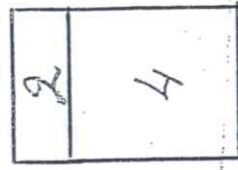

BAR

VESTIAIRE

accès  
salle

130 Places  
130  
Piste de  
Danse

MALL D'ENTRÉE

CUISINES

TOILETTE



ENTRÉE